

Order no.: 115139

Folding scaffolding 0.75 x
1.80 m with outrigger
Platform height 4.04 m



Accessories for the product family



Order no.: 027992

Safety railing for mobile scaffolding

A safety railing component consisting of a horizontal bar supported by two vertical posts, with orange-colored outriggers at the base.

Order no.: 027971

Folding frame unit, 0.75 m For scaffolding length: 1.8 m

A rectangular folding frame unit with a central vertical post and horizontal cross-bracing.

Order no.: 027904

Push-fit frame, 0.75 m. Height: 2.00 m

A vertical push-fit frame with horizontal rungs.

Order no.: 027955

Railing lengthwise 1,800 mm

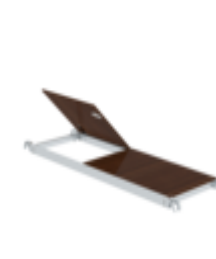
A horizontal railing component consisting of two parallel bars connected by a central crossbar.

Order no.: 027931

Platform with trapdoor For scaffolding length: 1.8 m

A rectangular platform with a dark-colored trapdoor in the center.

Order no.: 027913

Toe board front side For scaffolding width: 0.75 m

A rectangular toe board component.

Order no.: 027943

Toe board long side For scaffolding length: 1.8 m

A rectangular toe board component.

Order no.: 027937

Diagonal brace 1.8 m

A diagonal brace component.

Order no.: 027935

Horizontal strut For scaffolding length: 1.8 m

A horizontal strut component.

Order no.: 027926

Triangular outrigger

A triangular outrigger component.



Order no.: 027973

Swivel castor with spindle height adjustable Ø 125 mm



Order no.: 027940

Step-on bracket



Order no.: 027912

Ballast weight with hanging brackets RAL 1021

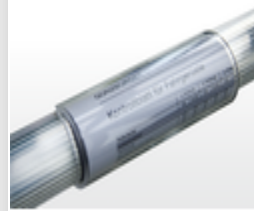

Order no.: 019081

Clip tray for tubes Ø 50 mm



Order no.: 027920

Wall spacer adjustable Adjustable up to 1.0 m



Order no.: 070506

Frame extension can be clamped on Adjustment range max. 400 mm



Order no.: 019274

Storage tray 500 x 220 mm Clamping range 38-51 mm



Order no.: 019276

Storage tray 800 x 300 mm Clamping range 38-51 mm



Order no.: 019175

Inspection sticker 40 x 40 mm



Order no.: 019176

Inventory sticker

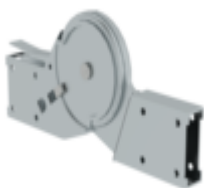

Order no.: 019477

Automatic steel hinge for scaffolding folding frame



Order no.: 070507

Safety door on front side Push-fit frame 0.75



Order no.: 019136

Spring clip for mobile scaffolding with short pin, closed



Order no.: 019137

Spring clip for mobile scaffolding with long pin, open



Order no.: 070524

Scaffolding strut telescopic 1,700-2,500 mm



Order no.: 027104

**Height-adjustable
spindle**



Order no.: 027922

**Swivel castor with
spindle, non-
marking grey height
adjustable Ø 200
mm**



Order no.: 027921

**Swivel castor with
spindle, electrically
conductive height
adjustable Ø 200
mm**



Order no.: 027958

**Swivel castor Ø
200 mm With
parking brake and
pin**



Order no.: 027905

**Push-fit frame, 0.75
m. Height: 1.00 m**